



BLUE ENGINEERING  
STEEL FABRICATION

## SECURITY

Bullet Resistant Doors, Windows & Facades  
Burglar Resistant Doors, Windows & Facades



## CATALOGUE

Blue Engineering (Pty) Ltd

Tel: 0608623991

Email: [info@blueengineering.co.za](mailto:info@blueengineering.co.za)

Web: [www.blueengineering.co.za](http://www.blueengineering.co.za)

**JANSEN** by   
ACCREDITED FABRICATION PARTNER

## Bullet Resistant Doors and Windows, Burglar Resistant Doors, Anti Burglary Doors, Security Doors and Anti Bandit Doors

Premium quality specialised steel bullet resistant doors and windows, steel burglar resistant doors, steel security doors and steel anti bandit doors for commercial, industrial and residential use, indoor or outdoor applications with great aesthetics.

Bullet resistant doors, windows and facades also known as bullet proof doors and bullet protection doors and are rated according to the calibre of weapon that they can withstand. For the structure FB4, FB5, FB6 and for the Glazing BR4, BR5, BR6

Burglar resistant doors, windows and facades, also known as anti burglary doors or security doors, are built and equipped with hardware to withstand forced entry  
The doors can also be certified if required according to tested ratings. RC1, RC2, RC3

Anti Bandit Doors is a typical South African term for doors that offer bullet resistance combined with burglar resistance and are rated according to the calibre of weapon they can withstand. G1, G2, G3, G4

In addition to offering bullet resistance and burglar resistance these doors can also be specified for fire and smoke protection and also blast resistance.

These upmarket specialised doors are manufactured using the latest proven and tested technologies and materials from Jansen in Switzerland. These doors are for those seeking to combine quality, strength, reliability, durability, function, performance and purpose with elegance.

Not just any doors, these are Jansen Doors.

Blue Engineering is a fully accredited fabrication partner for the Jansen system in South Africa.

## Glazed Bullet Resistant Door Construction

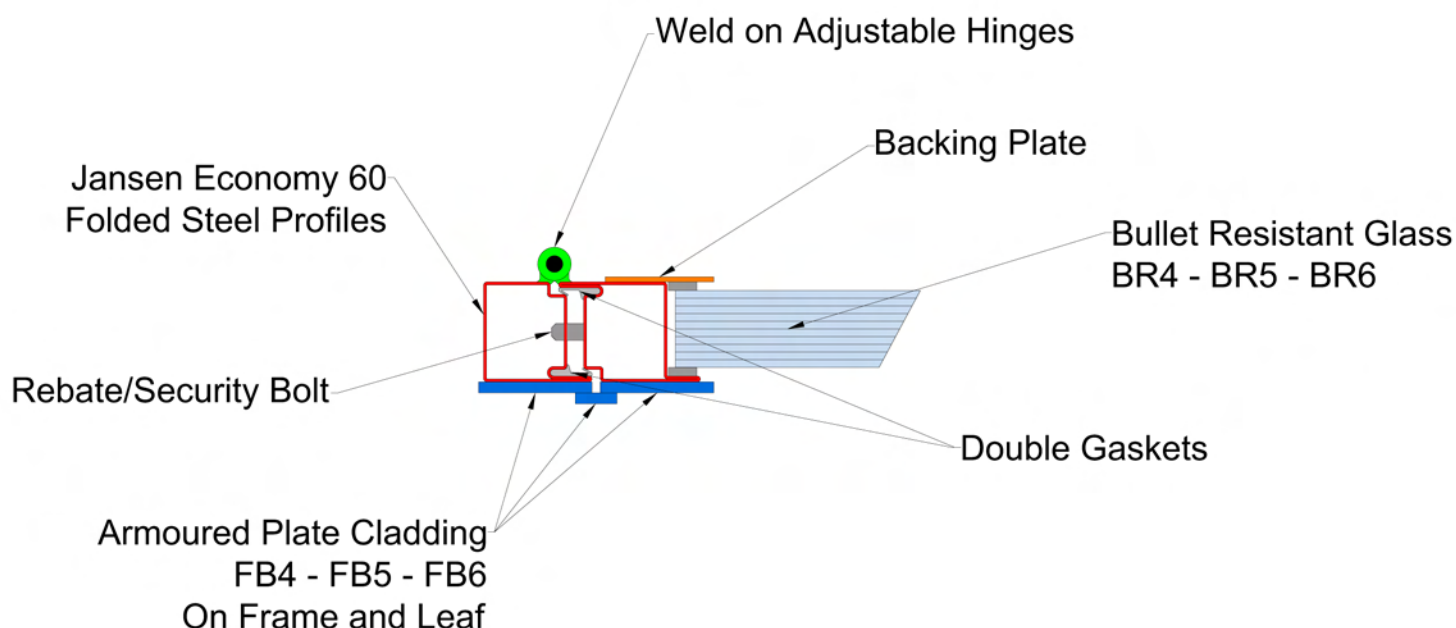

# Bullet and Burglar Resistant Doors, Windows and Facades

## We offer our doors as follows:

- Bullet Resistant Doors: FB2, FB3, FB4, FB5, FB6
- Burglar Resistant Doors / Security Doors: High Security (RC1, RC2, RC3)
- Anti Bandit Doors: G1, G2, G3, G4
- Fire and Smoke Protection Doors: 30, 60, 90, 120 Minutes
- Blast Resistance Doors: 35Kpa
- Combinations of the above

All our doors are manufactured without any wood or boards and are full steel or full steel and glass. Not only does this offer stronger protection and durability with lower maintenance but it also allows for doors, windows and facades that are suitable for both indoors and outdoors that can withstand the elements.

The armoured steel plate cladding used is certified and tested according to the rating of the door.

Please note: We do not use wear plate like VRN which is suitable for many industrial applications but is not tested and certified for bullet resistance.

The armoured plate used is Industeel SAFE 500 and MARS 600 manufactured in France and is tested and certified for bullet resistance and also specified for military applications.

The bullet resistant glass is sourced locally from Phoenix Glass, and is either standard laminated glass or laminated composite glass which is thinner and lighter. Bullet Blok glazing is tested and certified.

Whilst everything written is about doors, it also applies to windows and facades.



## Steel Bullet Resistant Door Construction

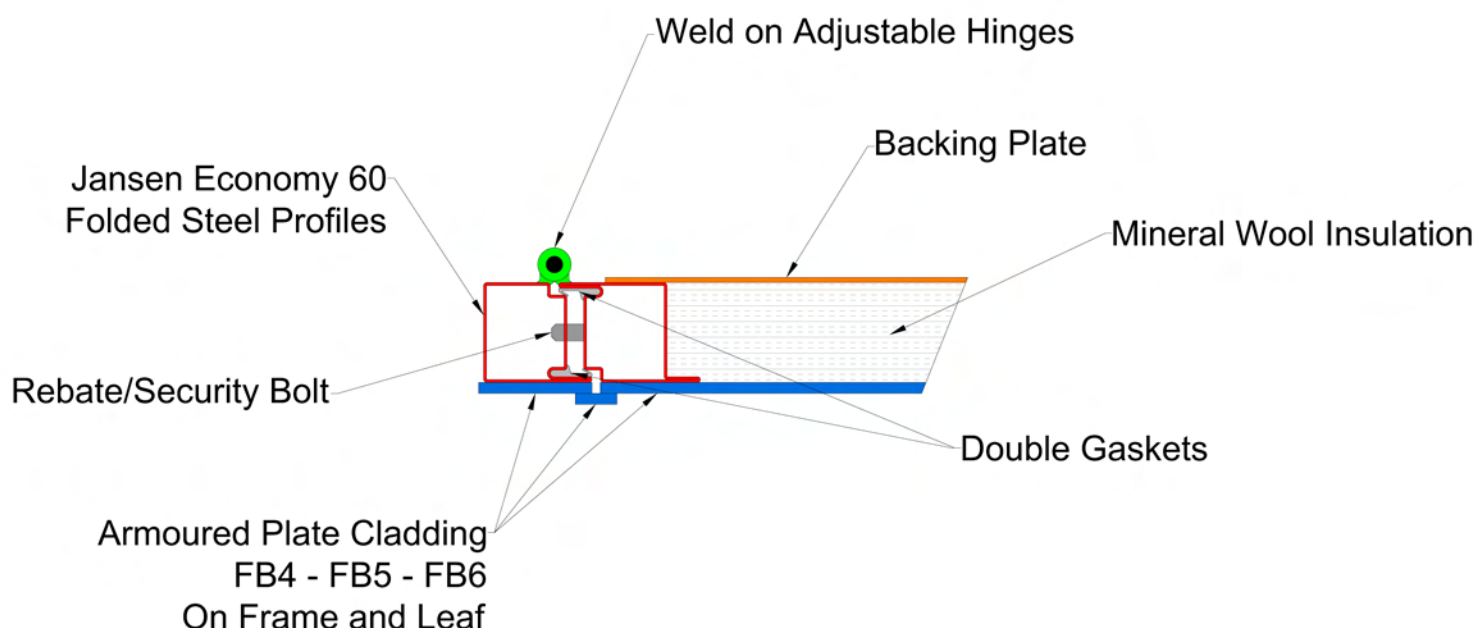

## Bullet Resistant Door, Windows and Facades Classifications

FB and BR classifications are as per EU and international specifications

FB Ratings are for the door itself and any cladding.

BR Ratings are for the Glazing

- FB1/BR1 – 22LR
- FB2/BR2 – 9mm
- FB3/BR3 – 9mm, 357 Magnum
- FB4/BR4 – 9mm, 357 Magnum, 44 Remington, 12 Gauge Shot Gun using Buckshot
- FB5/BR5 – All of the above, 5.56x45, 7.62x39 (AK47), 12 Gauge Shot Gun using Brenneke Slugs
- FB6/BR6 – All of above, 7.62x51 (R1, 308)

## Anti Bandit Doors

Anti Bandit Doors are our standard South Africa classifications for doors that have both Bullet Resistance and Anti Burglary Features

- G1 – 9mm
- G2 – 9mm, 357 Magnum, 44 Remington, 12 Gauge Shot Gun using Buckshot
- G3 – All of the above, 5.56x45, 7.62x39 (AK47), 12 Gauge Shot Gun using Brenneke Slugs
- G4 – All of above, 7,76x51 (R1, 308)

## A comparison of FB and Anti Bandit Bullet Resistance Classifications

- FB2 = G1
- FB4 = G2
- FB5 = G3
- FB6 = G4

## Anti Burglary Security Doors, Windows and Facades

Anti Burglary Security Doors are doors with enhanced security features to make it more difficult to be broken into requiring more tools, time and experience to get through the door.

These security features are typically upgraded locks, locks with more locking points, lock protection, rebate security bolts (Dog bolts) and physical upgrades to the door itself like thicker glazing, cladding or automatic closers can be added to keep the door closed and secure.

## Certified Security

The doors can also be offered with certified burglar resistance security classifications if required  
RC1, RC2, RC3

## Fire and Smoke Protection

The doors can offer further protection by adding fire and smoke protection features with upgrades to the gaskets, glazing, adding insulation, automatic closers and drop seals.



# Bullet and Burglar Resistant Doors, Windows and Facades

## Bullet Resistant Doors

For external or internal use.

### Offered in:

- FB2, FB3, FB4, FB5 and FB6 Bullet Resistance Specification
- G1, G2, G3, G4 Anti Bandit Specification

### Standard Features:

- All steel construction with Jansen Economy 60 folded steel profiles
- Cladding with armoured steel plate according to specification
- Bullet resistant glazing or composite glazing according to specification
- Double gaskets around the door
- Wrap around frame or automatic drop seals
- Concealed automatic closers (Dorma ITS86)
- Rebate/Security bolts
- Heavy duty Dia. 20x220 adjustable weld on hinges
- Multi point locking

### Optional Extra Features

- Fire and Smoke Protection 30, 60, 90 or 120 minutes
- Blast Protection
- Insulation
- High Security or Certified RC1, RC2, RC3 security rating
- Electric locking for access control
- Emergency Exit Function or Emergency Panic Push Bars

### Finishes

- Powder Coated
- Galvanised and Powder Coated



# Bullet and Burglar Resistant Doors, Windows and Facades

## Typical Glazed Steel Bullet Resistant Doors

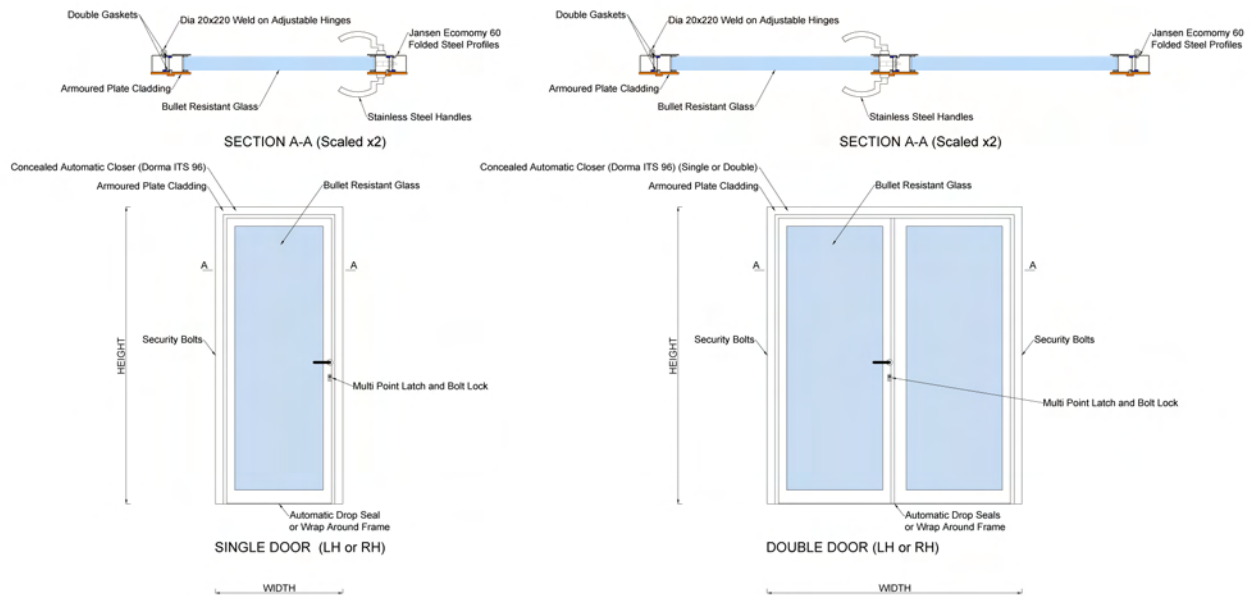

## Typical Steel Bullet Resistant Doors

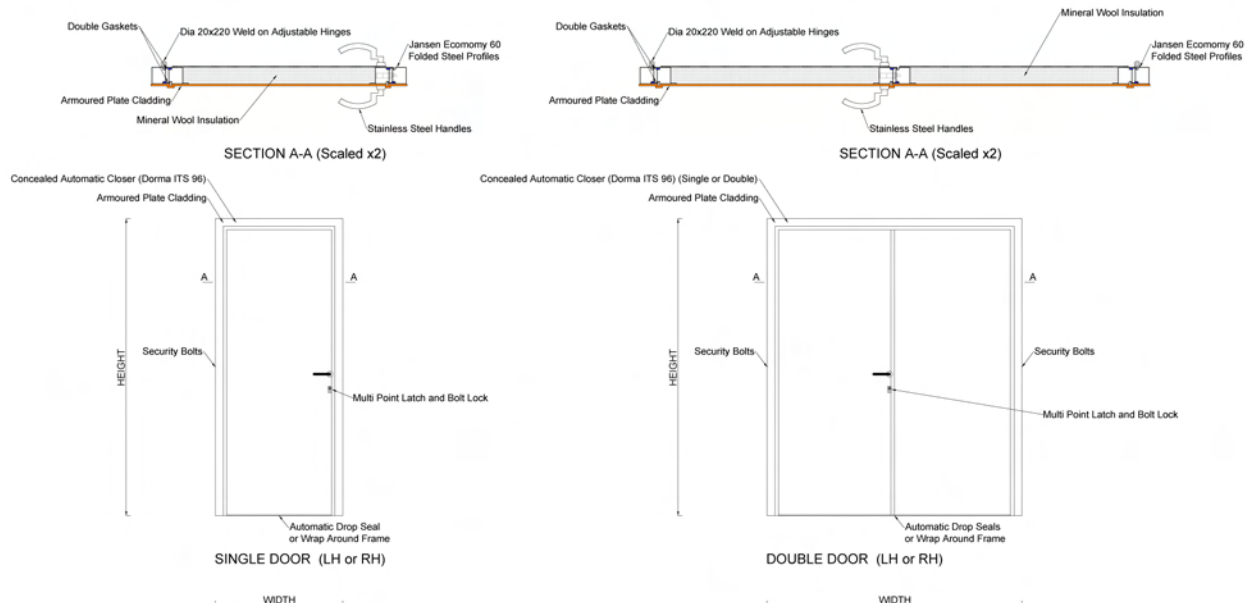

## Typical Steel Bullet Resistant Doors with Viewing Pane

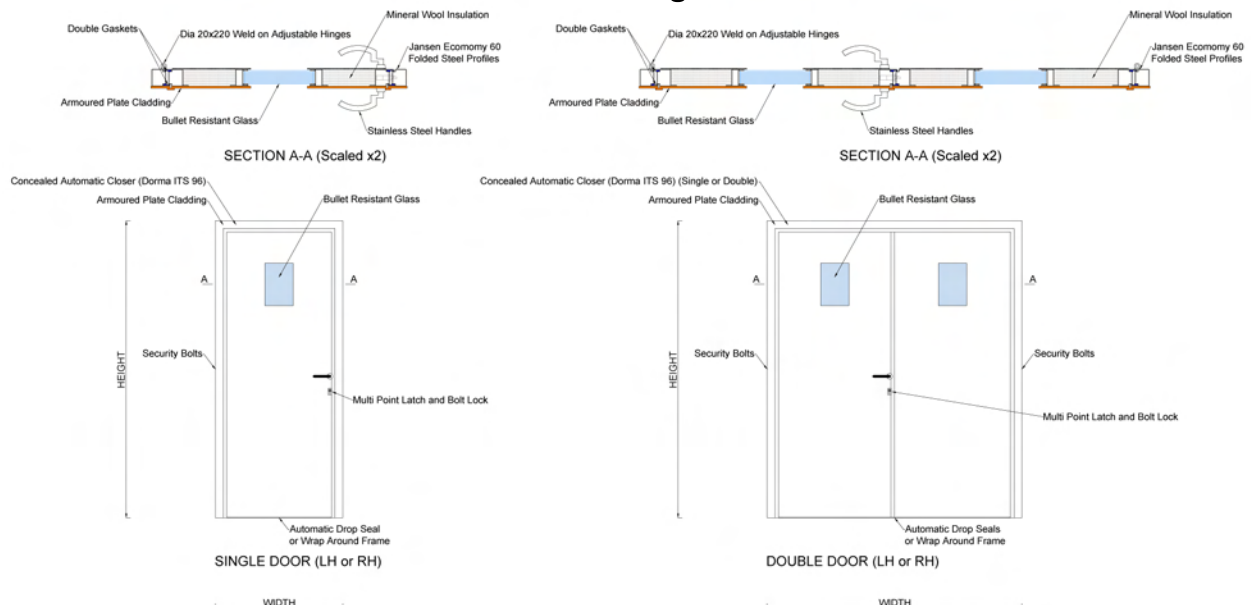

## Burglar Resistant Security Doors

These doors have many uses and can be used anywhere where high security is required for internal and external use. These doors can also be used for records rooms or as strong room doors.

### Standard Features:

- All steel construction with Jansen Economy 50 or 60 folded steel profiles
- TSG Armourlam Glazing or other options for higher security
- Steel Inserts or Cladding 3mm, 4mm, 5mm or 6mm Steel Plate
- Double gaskets around the door
- Wrap around frame or automatic drop seals
- Rebate/Security bolts
- Heavy duty Dia. 20x180 adjustable weld on hinges
- Multi point locking

### Optional Extra Features

- Fire and Smoke Protection 30, 60, 90 or 120 minutes
- Insulation
- Viewing Pane
- Concealed automatic closers (Dorma ITS86)
- High Security or Certified RC1, RC2, RC3 security rating
- Wrap around frame or automatic drop seals
- Electric locking for access control
- Emergency Exit Function or Emergency Panic Push Bars

### Finishes

- Powder Coated
- Galvanised and Powder Coated

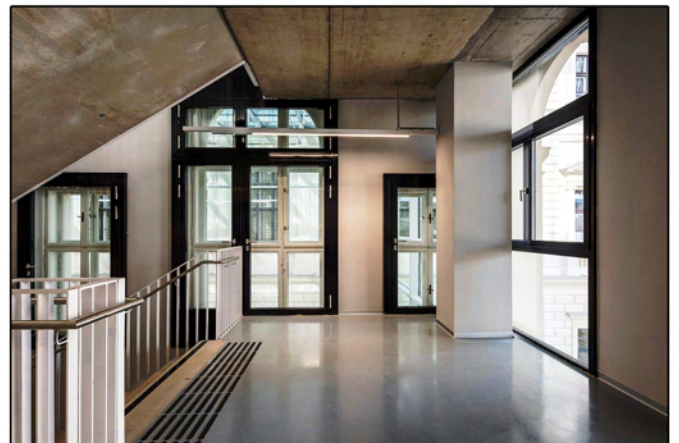



# Bullet and Burglar Resistant Doors, Windows and Facades

## Typical Glazed Steel Burglar Resistant Security Doors

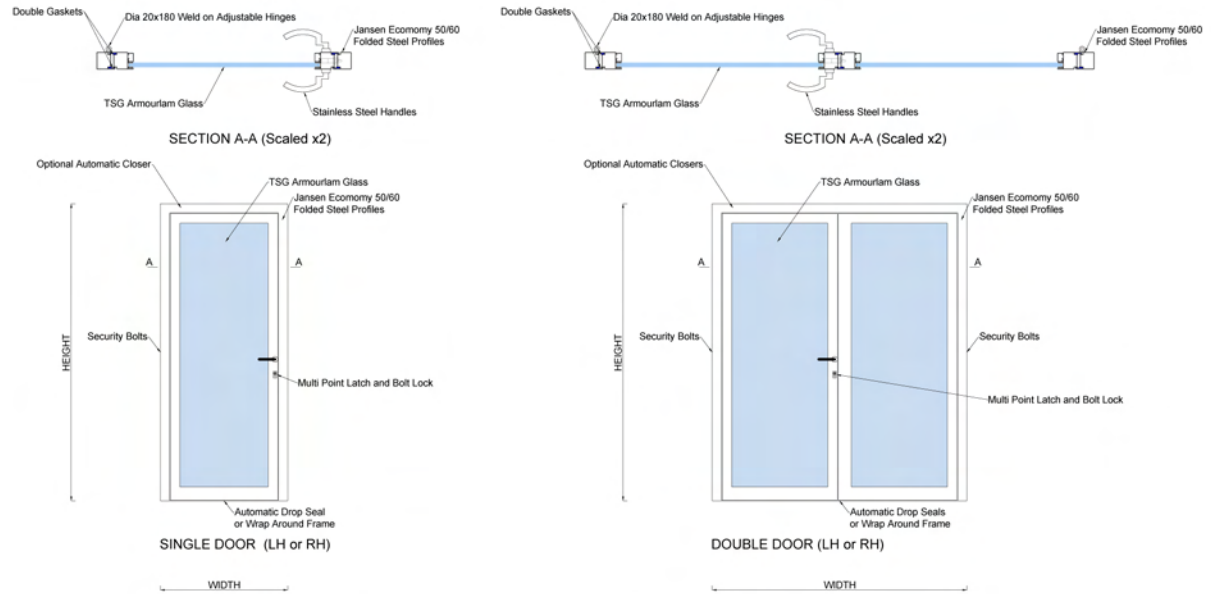

## Typical Steel Burglar Resistant Security Doors

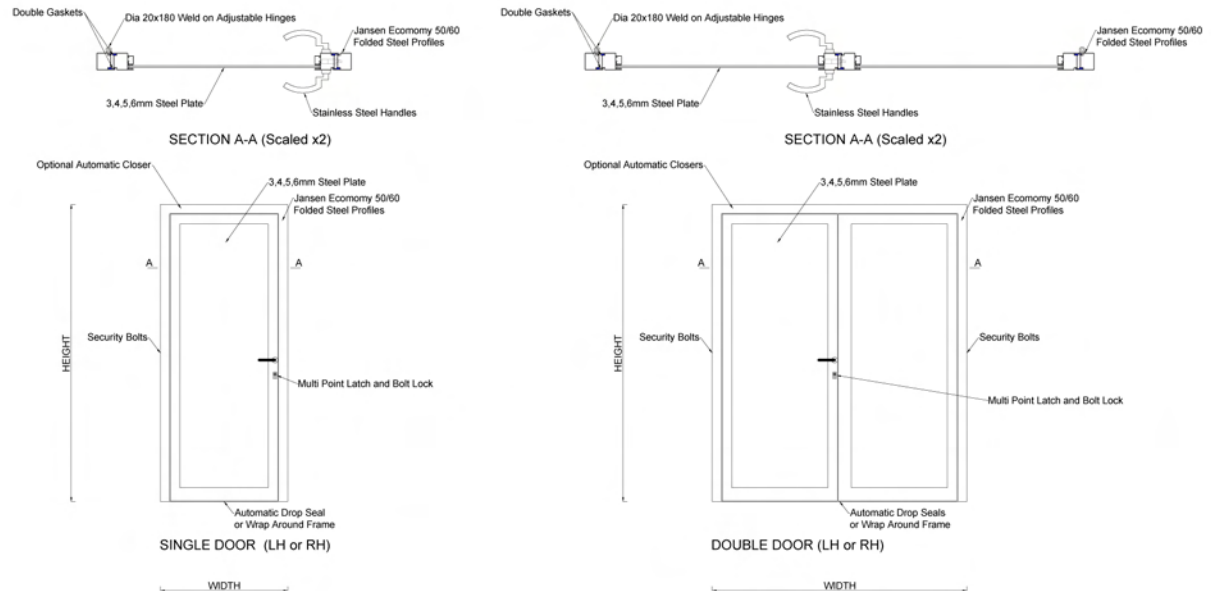

## Typical Clad Steel Burglar Resistant Security Doors

